

## NASS-B SMA to SMA

Features:  
\* Low VSWR

Applications:  
\* Wireless  
\* Transmitter  
\* Laboratory Test  
\* Radar

### Electrical

Frequency: DC~26.5GHz  
DC~18GHz (Right angle, reversed polarity)  
VSWR: 1.2 max.  
Impedance: 50Ω

### Mechanical

RF Connectors: SMA  
Mating Life Cycle: 500 cycles  
Outer Conductor: Gold plated brass  
Dielectric: PTFE  
Inner Conductor: Gold plated brass or Gold plated beryllium copper

### Environmental

Temperature: -55~+85°C

### Outline Drawings

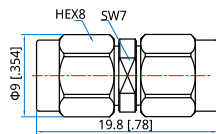

Outline A

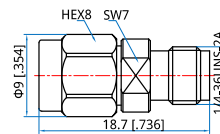

Outline B

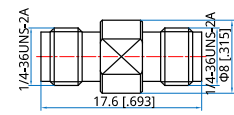

Outline C

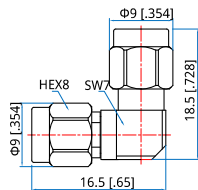

Outline D

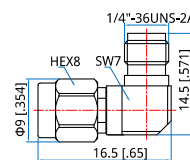

Outline E

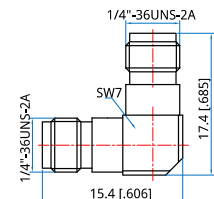

Outline F

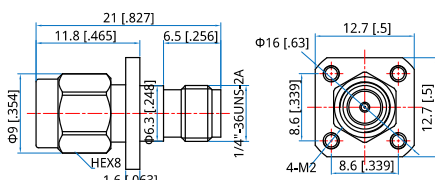

Outline G

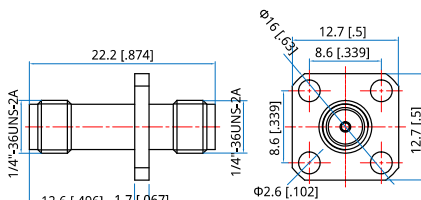

Outline H

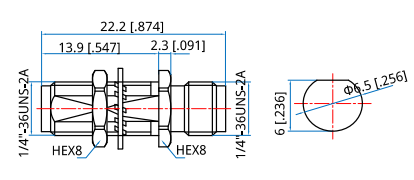

Outline I

Unit: mm [in]

Tolerance: ±0.2mm [±0.008in]

### How To Order

**NASS-MM-B** - SMA(m) to SMA(m), Outline A

**NASS-MF-B** - SMA(m) to SMA(f), Outline B

**NASS-FF-B** - SMA(f) to SMA(f), Outline C

**NASSR-MM-B** - SMA(m) to SMA(m), Right angle, Outline D

**NASSR-MF-B** - SMA(m) to SMA(f), Right angle, Outline E

**NASSR-FF-B** - SMA(f) to SMA(f), Right angle, Outline F

**NASSL-MF-B** - SMA(m) to SMA(f), Flange mount, Outline G

**NASSL-FF-B** - SMA(f) to SMA(f), Flange mount, Outline H

**NASSH-FF-B** - SMA(f) to SMA(f), Bulk head, Outline I

**NASS-MRPM-B** - SMA(m) reversed polarity to SMA(m), Outline A

**NASS-MRPMRP-B** - SMA(m) reversed polarity to reversed polarity SMA(m), Outline A

**NASS-MRPF-B** - SMA(m) reversed polarity to SMA(f), Outline B

**NASS-MFRP-B** - SMA(m) to SMA(f) reversed polarity , Outline B

**NASS-MRPFPRP-B** - SMA(m) reversed polarity to SMA(f) reversed polarity, Outline B

**NASS-FRPF-B** - SMA(f) reversed polarity to SMA(f), Outline C

**NASS-FRPFPRP-B** - SMA(f) reversed polarity to SMA(f) reversed polarity , Outline C

Customization is available upon request.