

NCT5002

DC~50GHz, 2W

Features:
 * Low VSWR
 * Broadband

Applications:
 * Transmitters
 * Antennas
 * Laboratory Test
 * Impedance Matching

Electrical

Frequency Range: DC~50GHz
 Average Power⁺¹: 2W
 Impedance: 50Ω
 VSWR: 1.4 max.

[1] Derated linearly to 0.1W@120°C.

Mechanical

Size⁺²: Φ8*24.2mm
 Φ0.315*0.953in
 Size⁺³: Φ8*22.3mm
 Φ0.315*0.878in
 Weight: 5g
 Connectors: 2.4mm
 Housing: Aluminum
 Outer Conductor: Gold plated brass or stainless steel
 Male Inner Conductor: Gold plated brass
 Female Inner Conductor: Gold plated beryllium copper

[2] 2.4mm male.

[3] 2.4mm female.

Environmental

Temperature: -55~+85°C

Outline Drawings

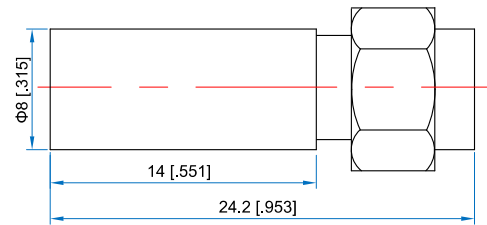

Outline A

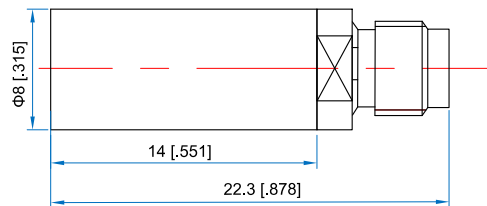

Outline B

Unit: mm [in]

Tolerance: ±0.2mm [±0.008in]

How To Order

NCT5002-X-Y

X: Frequency in GHz

Y: Connector type

Connector naming rules:

2 - 2.4mm male (Outline A)

2F - 2.4mm female (Outline B)

Examples:

To order a termination, DC-50GHz, 2.4mm male, specify NCT5002-50-2.

Customization is available upon request.