

NELC-2-2

2.4mm, DC~50GHz

Features:

- * Low VSWR
- * No welding
- * Reusable
- * Easy installation

Applications:

- * Laboratory Test

Electrical

Frequency: DC~50GHz
 VSWR: 1.3 max.
 Impedance: 50Ω

Mechanical

RF Connector: 2.4mm
 Outer Conductor: Passivated stainless steel
 Dielectric: PEI & PTFE
 Inner Conductor: Gold plated beryllium copper

Environmental

Temperature: -55~+165°C

How To Order

NELC-2-2 - Outline A

NELC-2F-2 - Outline B

Customization is available upon request.

Outline Drawings

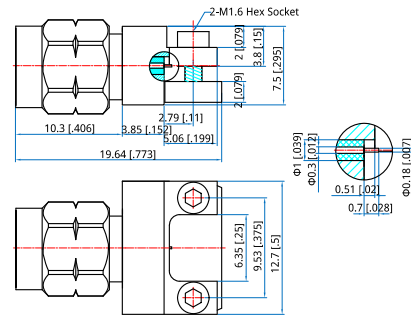

Outline A

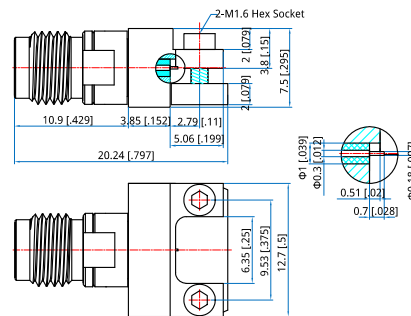

Outline B

Unit: mm [in]
 Tolerance: ±0.2mm [±0.008in]