

# NELC-K-2

## 2.92mm, DC~40GHz

- |   |   |
|---|---|
| <b>Features:</b><br>* Low VSWR<br>* No welding<br>* Reusable<br>* Easy installation | <b>Applications:</b><br>* Laboratory Test |
|---|---|

### Electrical

Frequency: DC~40GHz  
 VSWR: 1.25 max.  
 Impedance: 50Ω

### Mechanical

RF Connector: 2.92mm  
 Outer Conductor: Passivated stainless steel  
 Dielectric: PEI & PTFE  
 Inner Conductor: Gold plated beryllium copper

### Environmental

Temperature: -55~+165°C

### How To Order

- NELC-K-2 - Outline A
- NELC-KF-2 - Outline B

Customization is available upon request.

### Outline Drawings

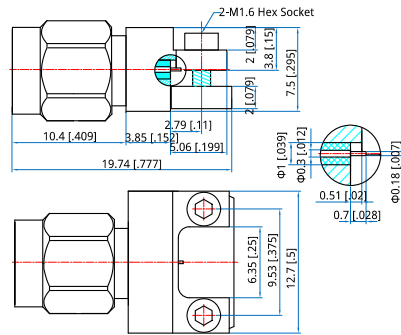

Outline A

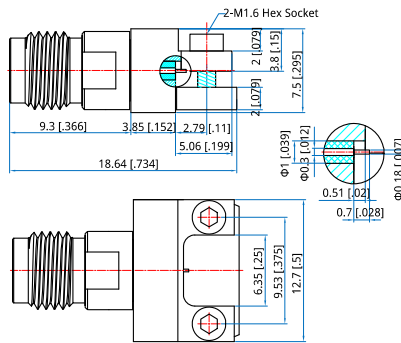

Outline B

Unit: mm [in]  
 Tolerance: ±0.2mm [±0.008in]