

NFA0602

DC~6GHz, 2W

- | | |
|-----------------------------|-------------------|
| Features: | Applications: |
| * Low VSWR | * Wireless |
| * High Attenuation Flatness | * Transmitter |
| | * Laboratory Test |
| | * Radar |

Electrical

Frequency: DC~6GHz
 Attenuation: 1~30dB
 Impedance: 50Ω
 Average Power: 2W

Mechanical

RF Connectors: SMA
 Weight: 5g

Environmental

Temperature: -55~+125°C

Outline Drawings

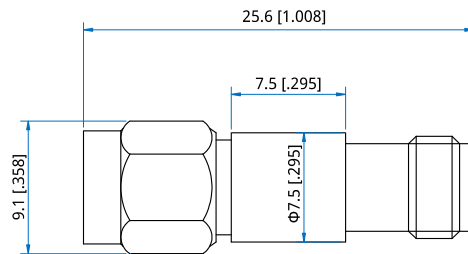

Unit: mm [in]
 Tolerance: ±3%

Attenuation Accuracy and VSWR (SMA)

Frequency (GHz)	Attenuation Accuracy (±dB) vs. Attenuation (dB)			VSWR (max.)
	1~10	11~20	21~30	
DC~6	±0.6	±0.8	±1.0	1.2

How To Order

NFA0602-X-Y-Z

- X: Frequency in GHz
 Y: Attenuation in dB
 Z: Connector type

Connector naming rules:
 S -SMA male&SMA female

Examples:
 To order an attenuator, DC~6GHz, SMA male to SMA female, 20dB attenuation, specify NFA0602-6-20-S.