

NSA28

DC~28GHz, 0~90dB, 25W

Features:

- * Low VSWR
- * High Attenuation Flatness

Applications:

- * Wireless
- * Transmitter
- * Laboratory Test
- * Radar

Description

NSA28 series Rotary Stepped Attenuators cover frequency range DC~28GHz. Rotary stepped attenuators can adjust the power level of microwave circuit in a certain frequency range by step.

Specifications

Frequency (GHz)	Attenuation Range/Step (dB)	VSWR (Max.)	IL (dB Max.)	Attenuation Accuracy (±dB)	Avg Power (W)	Connectors
DC~18		1.6	1	0.8	2, 10	SMA, 3.5mm
DC~26.5	0~9/1	1.7	1.8	1		
DC~28		1.75	1.8	1.5	10	
DC~18	0~70/10	1.6	1	1.5 or 4%	2,10	SMA, 3.5mm
DC~26.5	0~60/10	1.75	1.8	1.5 or 4%	2, 10	SMA, 3.5mm
0.1~8						SMA, 3.5mm
0.1~12.4	0~90/10	1.6	1	1.5 or 4%	2, 10	
0.1~18						
DC~18		1.6	1	1.5 or 4%		SMA, 3.5mm
DC~26.5	0~70/10	1.75	1.8	1.5 or 4%	25	
DC~28		1.75	1.8	2 or 5%		

Electrical

Impedance: 50Ω
Peak Power^{*1}: 200W

[1] Pulse width: 5us, duty cycle: 1%.

Mechanical

Size: 106*62/66*83mm
4.173*2.441/2.598*3.268in
Weight: 525g
RF Connectors: 3.5mm Female, SMA Female
Housing Materials: Aluminum

Environmental

Temperature: 0~+54°C

How To Order

NSA28-W-X-Y-Z

W: Stop Frequency in GHz
X: Maximum attenuation in dB
Y: Power in Watts
Z: Connector type

Connector naming rules:

S - SMA Female
3 - 3.5mm female

Examples:

To order an attenuator, DC~28GHz, 0~70dB attenuation, 2W, 3.5mm female, specify NSA28-28-70-2-3.

Customization is available upon request.

Outline Drawings

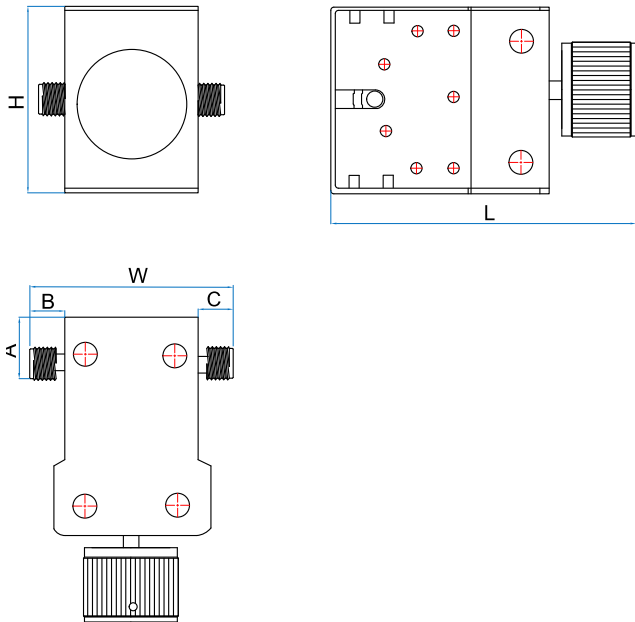

2W:60-90dB, 10W:1-90dB						
Size	L	W	H	A	B	C
mm	106	62	83	14	7	7
in	4.173	2.441	3.268	0.551	0.276	0.276
2W:1-9dB						
Size	L	W	H	A	B	C
mm	106	66	83	14	10.5	7
in	4.173	2.598	3.268	0.551	0.413	0.276
25W:70dB						
Size	L	W	H	A	B	C
mm	106	66	83	-	-	-
in	4.173	2.598	3.268	-	-	-

Unit: mm [in]

Tolerance: ±1mm [±0.04in]