

## NSA40

DC~40GHz, 0~9dB, 2W

### Features:

- \* Low VSWR
- \* High Attenuation Flatness

### Applications:

- \* Wireless
- \* Transmitter
- \* Laboratory Test
- \* Radar

### Description

NSA40 series Rotary Stepped Attenuators cover frequency range DC~40GHz. Rotary stepped attenuators can adjust the power level of microwave circuit in a certain frequency range by step.

### Specifications

Frequency (GHz)	Attenuation Range/Step (dB)	VSWR (Max.)	IL (dB Max.)	Attenuation Accuracy ( $\pm$ dB)	Avg Power (W)	Connectors
DC~32	0~9/1	1.8	2	1.2	2	2.92mm,
DC~40		1.9	2.2	1.5		3.5mm

### Electrical

Impedance: 50 $\Omega$   
Peak Power\*1: 200W

[1] Pulse width: 5 $\mu$ s, duty cycle: 2%.

### Mechanical

Size: 106\*62/66\*83mm  
4.173\*2.441/2.598\*3.268in  
Weight: 520g  
Housing Materials: Aluminum

### Environmental

Temperature: 0~+54 $^{\circ}$ C

### How To Order

#### NSA40-W-X-Y-Z

- W: Stop Frequency in GHz
- X: Maximum attenuation in dB
- Y: Power in Watts
- Z: Connector type

#### Connector naming rules:

- K - 2.92mm Female
- 3 - 3.5mm female

#### Examples:

To order an attenuator, DC~40GHz, 0~9dB attenuation, 2W, 2.92mm female, specify NSA40-40-9-2-K.

Customization is available upon request.

### Outline Drawings

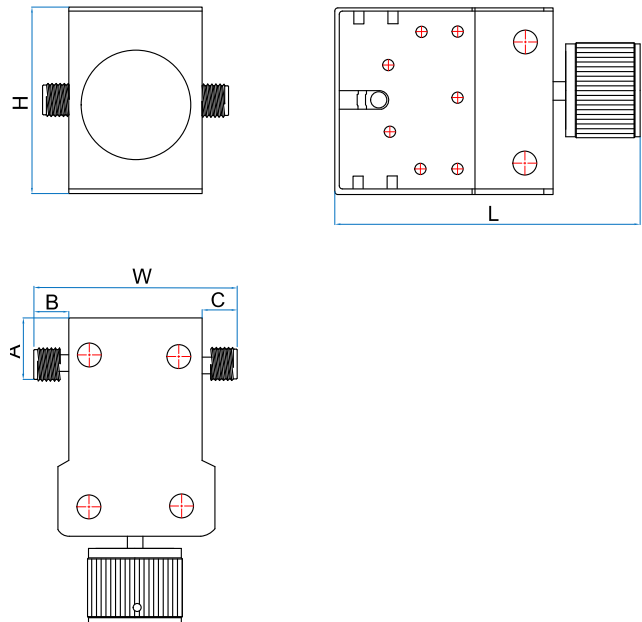

Size	L	W	H	A	B	C
mm	106	66	83	14	10.5	7
in	4.173	2.598	3.268	0.551	0.413	0.276

Unit: mm [in]

Tolerance:  $\pm$ 1mm [ $\pm$ 0.04in]