

NVLC-2F-1
DC~50GHz

Features:
* Low VSWR

Applications:
* Wireless
* Radar
* Instruments
* Electronics

Electrical

Frequency: DC~50GHz
VSWR: 1.2 max.
Impedance: 50Ω

Mechanical

RF Connector: 2.4mm female
Outer Conductor: Passivated SU303 stainless steel
Inner Conductor: Gold plated beryllium copper

Outline Drawings

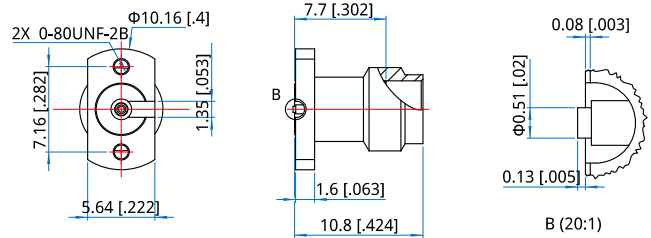

Unit: mm [in]
Tolerance: ±0.2mm [±0.008in]

How To Order
NVLC-2F-1

Customization is available upon request.