

NTW-10
WR-10

Features:
* Low VSWR
* High Isolation

Applications:
* Wireless
* Transmitter
* Laboratory Test
* Radar

Electrical

Frequency: 73.8~110GHz
VSWR: 1.15 max.

Mechanical

Size: 50.8* Φ 19.1mm
2* Φ 0.752in
Waveguide Size: WR-10 (BJ900)
Flange: UG387/UM
Material: Brass
Finish: Gold-plating

Outline Drawings

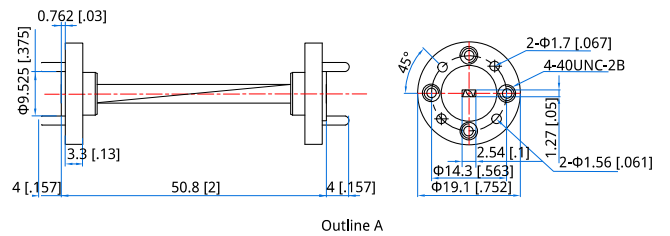

Unit: mm [in]
Tolerance: \pm 0.2mm [\pm 0.008in]

How To Order

NTW-10-X-Y-

X: Length in mm.
Y: Material
Z: Flange type

Length in mm:
50.8 - 50.8mm (Outline A)

Material naming rules:
B - Brass (Outline A)

Flange naming rules:
12 - UG-387/UM (Outline A)

Examples:
To order a Waveguide Twist, WR-10, 50.8mm, Brass, UG-387/UM, specify NTW-10-50.8-B-12.

Customization is available upon request.