

**NTW-10**  
WR-10

Features:  
\* Low VSWR  
\* High Isolation

Applications:  
\* Wireless  
\* Transmitter  
\* Laboratory Test  
\* Radar

**Electrical**

Frequency: 73.8~110GHz  
VSWR: 1.15 max.

**Mechanical**

Size: 50.8\* $\Phi$ 19.1mm  
2\* $\Phi$ 0.752in  
Waveguide Size: WR-10 (BJ900)  
Flange: UG387/UM  
Material: Brass  
Finish: Gold-plating

**Outline Drawings**

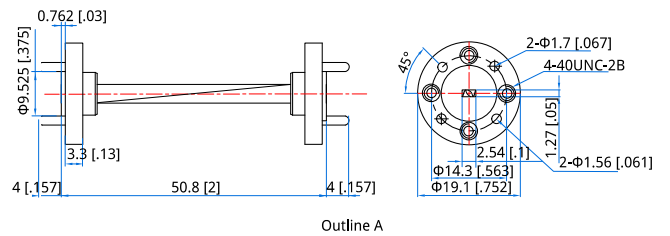

Unit: mm [in]  
Tolerance:  $\pm$ 0.2mm [ $\pm$ 0.008in]

**How To Order**

**NTW-10-X-Y-**

X: Length in mm.  
Y: Material  
Z: Flange type

Length in mm:  
50.8 - 50.8mm (Outline A)

Material naming rules:  
B - Brass (Outline A)

Flange naming rules:  
12 - UG-387/UM (Outline A)

Examples:  
To order a Waveguide Twist, WR-10, 50.8mm, Brass, UG-387/UM, specify NTW-10-50.8-B-12.

Customization is available upon request.

## NTW-15 WR-15

Features:  
 \* Low VSWR  
 \* High Isolation

Applications:  
 \* Wireless  
 \* Transmitter  
 \* Laboratory Test  
 \* Radar

### Electrical

Frequency: 50-75GHz  
 VSWR: 1.15 max.

### Mechanical

Size: L\* $\Phi$ 19.1mm  
 L\* $\Phi$ 0.752in  
 L:  $30 \leq L \leq 150$ mm  
 Waveguide Size: WR-15 (BJ620)  
 Flange: UG385/U  
 Material: Brass  
 Finish: Gold-plating

### Outline Drawings

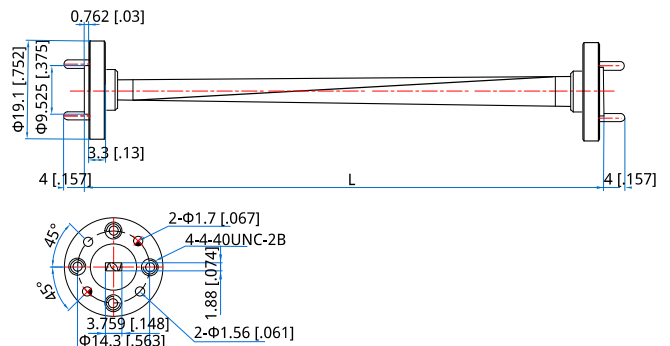

Outline A

Unit: mm [in]  
 Tolerance:  $\pm 0.05$ mm [ $\pm 0.002$ in]

### How To Order

#### NTW-15-X-Y-Z

X: Length in mm.  
 Y: Material  
 Z: Flange type

Length in mm:  
 30 - 30mm (Outline A)

Material naming rules:  
 B - Brass (Outline A)

Flange naming rules:  
 6 - UG385/U (Outline A)

Examples:  
 To order a Waveguide Twist, WR-15, 30mm, Brass, UG-385/U, specify NTW-15-30-B-6.

Customization is available upon request.